

**AESTHETIC ALTERNATIVE TO PALISADE**

Rigid and reliable, Nylofor® Medium is a trusted solution to demarcate and protect perimeters.

Nylofor Medium is a 2.5m wide panel providing flexibility when used on either smaller projects or projects with various directional changes.

Double wire reinforced V bends increases the panel's strength and protection level.

Stainless steel M8 tamper-proof bolts are bolted through the post and secured with shear-off nuts to provide maximum resistance against tampering.

All our products are engineered to the highest standards and manufactured locally in our ISO 9001 certified facility using superior anti-corrosion coating technologies.

Our products are backed by a 10 year guarantee when installed by one of our certified installer partners.

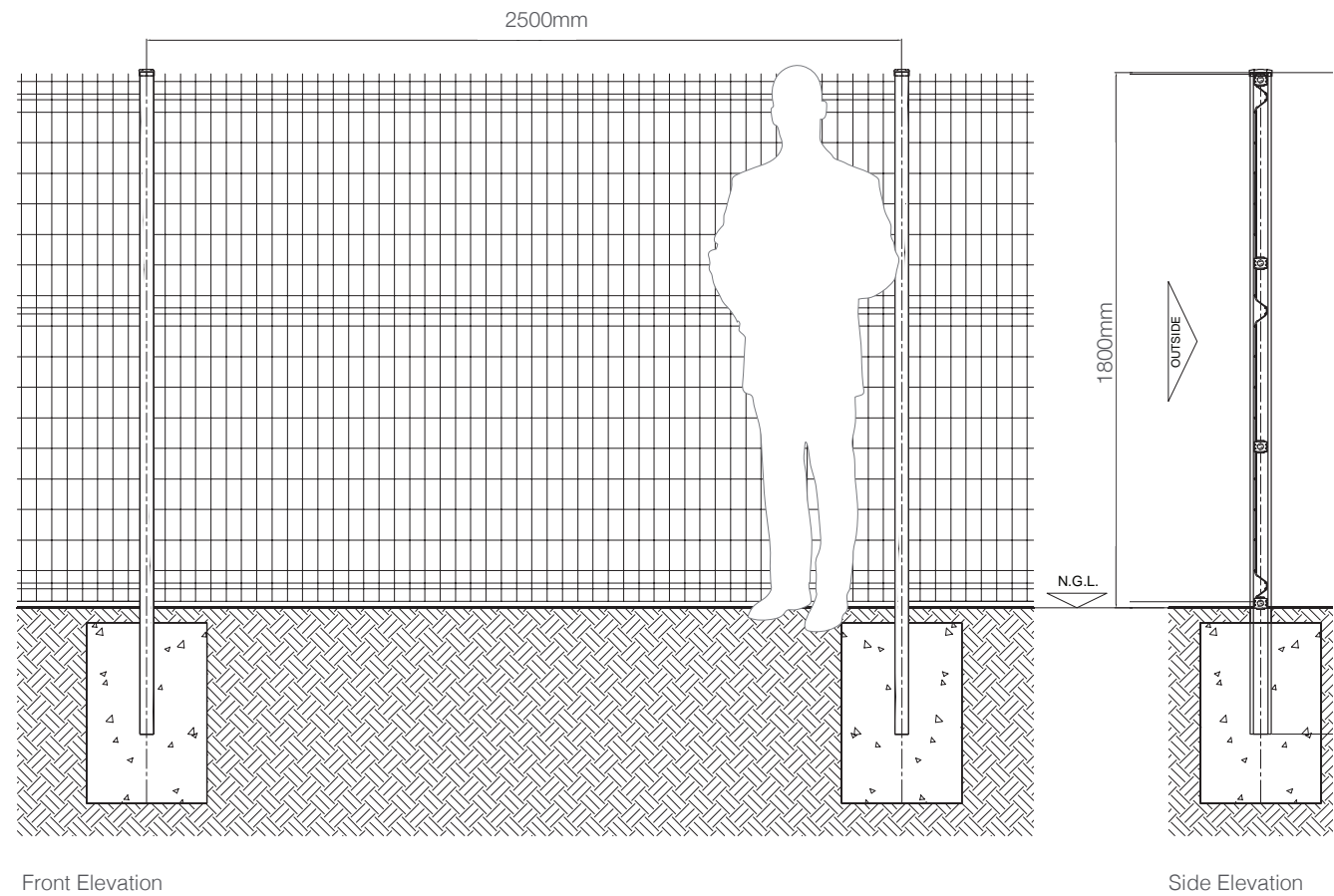

Bekafix® Secure post

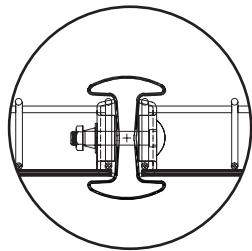

Top view panel & post fixing detail

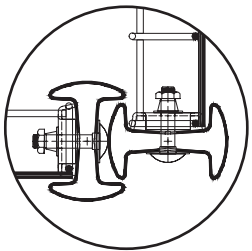

Top view corner detail

# NYLOFOR® MEDIUM

## PRODUCT DESCRIPTION

<b>Panels</b>	High-strength 2.5m wide mesh panel with a 100mm high and 50mm wide aperture, Nylofor Medium provides an ideal solution where aesthetics and high levels of visibility are required.
<b>Bekafix® Secure posts</b>	A hollow “H” profile post: 70mm x 44mm Made from a rolled sheet, then hot-dip galvanized and coated RAL 6005 Green or RAL 7021 Anthracite. A polyamide cap covers the top of the post.
<b>Fixing</b>	Behind the front lip using spider fixators and stainless steel security bolts, which go through the post for added security. Panels are then secured using tamper-proof shear-off nuts.

## DIMENSIONS

<b>Nominal fence height</b>	1200mm	1800mm	2000mm
<b>Panels Width x height</b>	2447mm x 1240mm	2447mm x 1750mm	2447mm x 2060mm
<b>Number of V bends per panel</b>	2	3	4
<b>Post length</b>	1600mm	2400mm	2700mm
<b>Number of fixators per Bekafix® post</b>	6	8	8
<b>Bolts (M8x50mm), washers &amp; shear-off nuts - Bekafix® Post</b>	3	4	4

## DOUBLE WIRE ADDS RIGIDITY

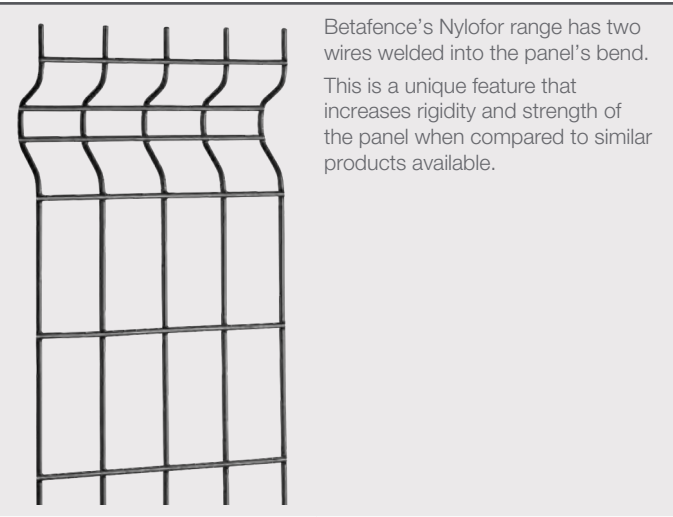

## OPTIONS

<b>Surveillance</b>	The panels feature excellent visibility when combined with surveillance systems.
<b>Colors</b>	RAL 6005 Green PVC RAL 7021 Anthracite PVC
<b>Electrics</b>	6 strands of electric fence on top of panel or a separate electric fence is fitted.

## SUPERIOR COATING

<b>ZincAlu Super</b>	A superior ZincAlu anti-corrosion coating proven to last nearly three times longer than hot dipped galvanized wires.
<b>PVC</b>	An additional PVC coating for maximum corrosion resistance. Color options: Green RAL 6005 and Anthracite RAL 7021.